

## Master Link Assemblies GT/S Grade 10

---

### Product information



Designed for larger crane hooks and special hooks.

... [Read more](#)

---

**Material:** Alloy steel.

**Finish:** Violet powder coated.

**Warning:** Not to be heat-treated.

**Safety factor:** 4:1

**Grade:** 10

## Master Link Assemblies GT/S Grade 10

### Blueprint

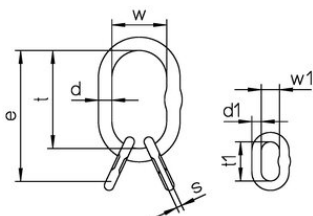

### Technical data

Part code	Code	WLL ton	EWL	d mm	d1 mm	e mm	s mm	t mm	t1 mm mm	w mm mm	w1mm mm	Weight kg
11.0245929	GT/S-6-10	4.2	214	19	13	214	10	160	54	95	25	1.47
11.0246055	GT/S-8-10	6.6	240	23	17	240	14	170	70	105	34	2.53
11.0246198	GT/S-10-10	10.1	275	27	20	275	14	190	85	110	40	3.87
11.0246211	GT/S-13-10	15.7	345	33	23	345	17	230	115	130	50	7.21
11.0246218	GT/S-16-10	21.2	415	38	27	415	20	275	140	150	65	11.3