

Connecting Link V/S Grade 10

Product information



Connecting link for: masterlink - chain, chain - chain, (eye)hook - chain

... [Read more](#)

Material: Alloy steel.

Marking: According to standard, CE-marked

Temperature range: -40°C up to 380°C

Finish: Violet powder coated.

Standard: EN 1677-1 (+ 25% WLL)

Note: Not to be heat-treated.

Warning: For straight in-line pull only. Not to be heat-treated.

Safety factor: 4:1

Grade: 10

Connecting Link V/S Grade 10

Blueprint

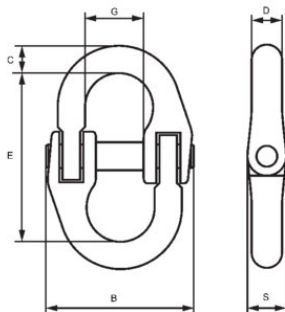

Technical data

| Part code | Code | WLL ton | For chain Ø mm | B mm | C mm | D mm | E mm | G mm | S mm | Weight kg |
|------------|-----------|---------|----------------|------|------|------|------|------|------|-----------|
| 11.0665653 | V/S 6 | 1.4 | 6 | 39 | 8 | 8 | 44 | 14 | 11 | 0.11 |
| 11.0669997 | V/S 7 | 1.9 | 7 | 47 | 10 | 9 | 51 | 17 | 13 | 0.2 |
| 11.0643430 | V/S 8 | 2.5 | 8 | 55 | 12 | 10 | 62 | 18 | 14 | 0.29 |
| 11.0643432 | V/S 10 | 4 | 10 | 64 | 15 | 13 | 72 | 24 | 18 | 0.52 |
| 11.0643426 | V/S 13 | 6.7 | 13 | 79 | 20 | 17 | 88 | 28 | 22 | 0.91 |
| 11.0665656 | V/S 16 | 10 | 16 | 106 | 21 | 21 | 103 | 33 | 29 | 1.34 |
| 11.0669998 | V/S 19/20 | 16 | 19-20 | 123 | 30 | 24 | 115 | 42 | 35 | 3.33 |
| 11.0691519 | V/S 22 | 19 | 22 | 148 | 34 | 25 | 161 | 51 | 39 | 3.14 |
| 11.0676492 | V/S 26 | 26.5 | 26 | 175 | 40 | 30 | 190 | 60 | 46 | 5.72 |