

Load Hook HKS/S Grade 10 - Clevis/Latch

Product information



Clevis Load hook - Sling hook with safety latch for general lifting applications
... [Read more](#)

Material: Alloy steel.

Marking: According to standard, CE-marked

Temperature range: -40°C up to 380°C

Finish: Violet powder coated.

Standard: EN 1677-2 (+25% WLL)

Warning: Not to be heat-treated.

Safety factor: 4:1

Grade: 10

Load Hook HKS/S Grade 10 - Clevis/Latch

Blueprint

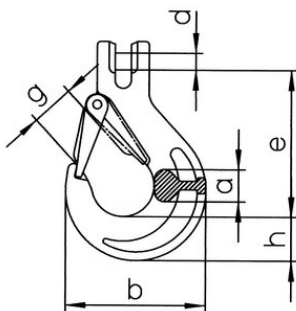

Technical data

Part code	Code	WLL ton	EWL mm	For chain Ø mm	a mm	b mm mm	dmm mm	e mm mm	g mm mm	h mm mm	Weight kg
11.1150416	HKS/S-6	1.4	69	6	15	66	7	69	19	20	0.25
11.1169968	HKS/S-7	1.9	95	7	19	90	9	95	26	28	0.68
11.1150418	HKS/S-8	2.5	95	8	19	90	10	95	26	28	0.58
11.1150419	HKS/S-10	4	109	10	25	108	12.5	109	31	35	1.14
11.1150420	HKS/S-13	6.7	136	13	34	131	16	136	39	41	2.02
11.1150421	HKS/S-16	10	155	16	37	153	20	155	45	49	3.57
11.1191481	HKS/S-19/20	16	184	19-20	51	177	24	184	53	53	5.55
11.1169970	HKS/S-22	19	214	22	52	196	27	214	62	62	8.99