

## Safety Hook HKSB/S Grade 10 - Clevis

---

### Product information



Component of chain slings, closes and locks automatically.

... [Read more](#)

---

**Material:** Alloy steel

**Marking:** According to standard, According to chain dimension

**Finish:** Violet powder coated.

**Standard:** EN 1677-3 (+ 25% WLL)

**Warning:** Not to be heat-treated

**Safety factor:** 4:1

**Grade:** 10

## Safety Hook HKSB/S Grade 10 - Clevis

### Blueprint

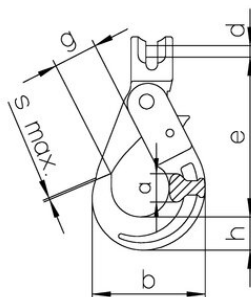

### Technical data

Part code	Code	WLL ton	EWL mm	For chain Ø mm	a mm	b mm mm	d mm mm	e mm mm	g mm mm	h mm mm	S max mm	Weight kg
11.1634638	HKSB/S-6-10	1.4	94	6	17	71	7.5	94	28	20	1	0.56
11.1669966	HKSB/S-7-10	1.9	123	7	20	88	9	123	34	26	1	0.87
11.1634639	HKSB/S-8-10	2.5	123	8	20	88	10	123	34	26	1	1
11.1634640	HKSB/S-10-10	4	144	10	29	107	12.5	144	45	30	1	1.61
11.1634642	HKSB/S-13-10	6.7	180	13	35	138	16	180	52	40	1.5	3.24
11.1634678	HKSB/S-16-10	10	218	16	41	168	20	218	60	50	2	5.95