

Foundry Hook KWB, GH/S Grade 10 - Eye

Product information



Foundry Hooks are hooks with a bigger opening without safety latch often used in foundries.

... [Read more](#)

Material: Alloy steel.

Marking: According to standard, CE-marked

Temperature range: -40°C up to 380°C

Finish: Violet powder coated.

Standard: EN 818-4

Note: Always verify if hooks without safety latch are allowed for your application.

Warning: Not to be heat-treated.

Safety factor: 4:1

Grade: 10

Foundry Hook KWB, GH/S Grade 10 - Eye

Blueprint

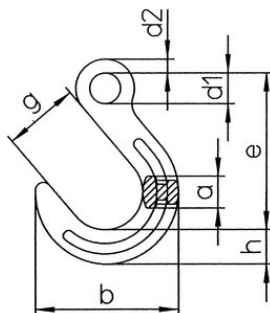

Technical data

Part code	Code	WLL ton	EWL mm	For chain Ø mm	a mm	b mm	d1 mm	d2 mm	e mm	g mm	h mm	Weight kg
11.1169963	GH/S-7/8	2.5	131	7-8	25	118	24	11	131	64	29	0.94
11.1169960	GH/S-10	4	158	10	32	143	31	14	158	76	35	1.62
11.1169961	GH/S-13	6.7	190	13	40	170	39	17	190	89	42	3.24
11.1169962	GH/S-16	10	224	16	46	200	47	22	224	102	50	5.65
11.1169959	GH/S-19/20	16	260	19	54	231	56	28	260	114	61	9.5