

## HJ G Gravity Return Hydraulic Cylinder

---

### Product information



Holmatro high tonnage cylinders (HJ) – Gravity return

#### Unique specifications:

- Flat saddle; prevents damage to the plunger, easy to replace with tilting saddle

#### Standard supplied with:

- High flow female coupler A118
- Flat saddle

#### Also available:

- Tilting saddles

#### Also available:

- Hydraulic pump units 700bar to control your system
- Hydraulic hoses 700bar
- System components to complete your hydraulic system

... [Read more](#)

---

**Material:** Steel

## HJ G Gravity Return Hydraulic Cylinder

### Blueprint

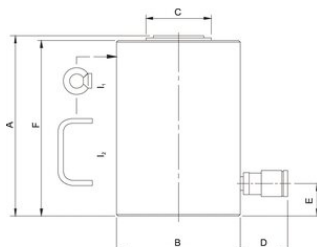

### Technical data

Part code	Code	WLL ton	stroke length mm	Closed height mm	required oil cc	Type	Weight kg
16.40100112035	HJ 50 G 15	50	150	282	1,064	I2	27
16.40100112036	HJ 50 G 30	50	300	463	2,127	I2	39.5
16.40100112073	HJ 50 G 6	50	60	142	425	-	12.5
16.40100112039	HJ 100 G 15	100	150	309	2,145	I1  mm	51
16.40100112040	HJ 100 G 30	100	300	497	4,290	I1  mm	82
16.40100112093	HJ 100 G 6	100	60	158	860	I2	29
16.40100112046	HJ 150 G 15	150	150	317	3,207	I1  mm	74.6
16.40100112047	HJ 150 G 30	150	300	502	6,414	I1  mm	125.3
16.40100112048	HJ 200 G 15	200	150	327	4,253	I1  mm	120
16.40100112050	HJ 300 G 15	300	150	382	6,225	I1  mm	238