

Electric Winch Type EN EMCE

Product information



General: A range of electric self braking worm gear winches, developed conform to the European norms for lifting winches, specially to P-82-NEN 3508-K3 and DIN 15020-1AM with long life service. The self braking worm gearbox is combined with an automatic fail-safe motor brake for precise load control. On types EN 580 to EN1700 a grooved drum is fitted as standard according to the CE norm. A grooved drum ensures long service life for the cable.

Standard features:

- Self braking worm gear transission.
- IP 54 aluminium braked motor 400 V-AC / 3 phase / 50 Hz.
- Grooved steel drum (not grooved on EN 200, EN 450) with cable fixing point at flange.
- Single drum support (EN 200, EN 450).
- Two drum supports (all other models).
- Double layer 2 component conservation, colour RAL 5010.

[... Read more](#)

Electric Winch Type EN EMCE

Blueprint

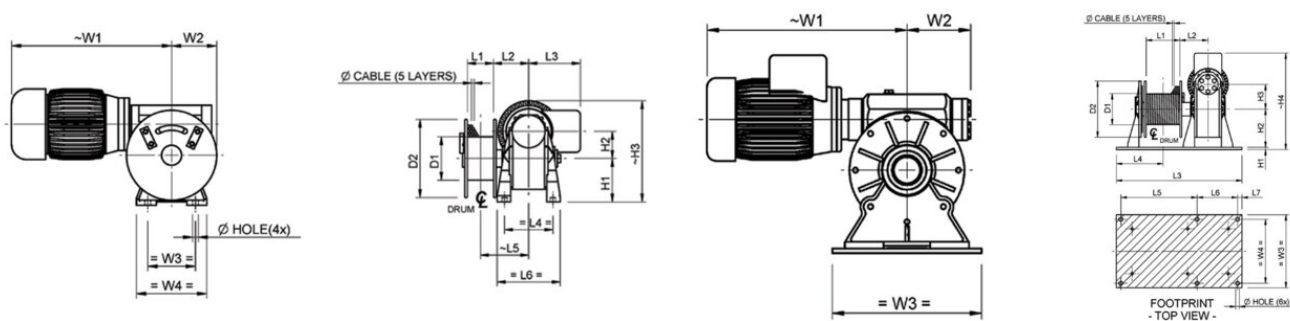

Technical data

Part code	WLL ton	Type	WLL top layer ton	Recomm. rope dia. mm	Motor kW	Speed 1st layer m/min	Drum capacity 1st layer m	Max. drum capacity m	Weight kg
4005061	0.2	EN 200	0.165	5	0.55	6	3	11	20
4005062	0.45	EN 450	0.375	6	1.1	7	3	11	35
4005063	0.5	EN 500	0.405	7	1.1	5.5	7	25	60
4005064	0.8	EN 800	0.64	8	1.5	6	6	23	90
4005065	1.05	EN 1050	0.84	10	3	7.5	9	31	150
4005066	1.325	EN 1325	1.065	11	4	8	11	40	195
4005067	1.7	EN 1700	1.37	12	5.5	9	13	48	260