

## Swivel hook Crosby L-322 AN

### Product information



### Features:

- Suitable for positioning of the hook before the load is lifted.
- Swivel hooks are load rated.
- Proper design, careful forging, and precision controlled quench and tempering gives maximum strength without excessive weight and bulk.
- Hoist hooks incorporate markings forged into the product which address two (2) QUIC-CHECK®
- Deformation Indicators -- Two strategically placed marks, one just below the shank or eye and the other on the hook tip, which allows for a QUIC-CHECK® measurement to determine if the throat opening has changed, thus indicating abuse or overload.
- Angle Indicators — Indicates the maximum included angle which is allowed between two (2) sling legs in the hook. These indicators also provide the opportunity to approximate other included angles between two sling legs ... [Read more](#)

**Material:** Alloy steel - Forged, Quenched & Tempered.

**Marking:** CE-marked

**Note:** This hook is a positioning device and is not intended to rotate under load.

**Safety factor:** 4:1

**Grade:** 8

## Swivel hook Crosby L-322 AN

### Blueprint

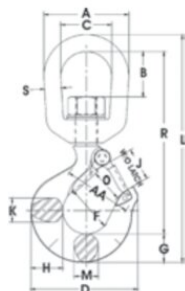

### Technical data

Part code	WLL ton	EWL mm	A mm	B mm	C mm	D, mm	F mm	G, mm	H, mm	L mm	O*mm mm	Rmm mm	S mm	AA**mm mm	Weight kg
11.101048807	1.25	116	51	20.8	31.8	72.5	31.8	18.5	20.6	144	23.6	116	9.65	38.1	0.34
11.101048816	1.6	136	63.5	33.3	38.1	80	35.1	21.3	23.9	170	24.6	136	12.7	50.8	0.57
11.101048825	2.5	155	76	38.1	44.5	91	38.1	25.4	29.5	187	26.9	155	16	50.8	1.02
11.101048834	3.2	165	76	38.1	44.5	102	41.1	28.7	33.3	210	29.5	165	16	50.8	1.04
11.101048840	5.4	191	89	41.7	50.8	123	51	36.6	41.4	246	35.8	191	19.1	63.5	2.25
11.101048859	8	245	116	58	63.5	160	63.5	46	52.5	317	42.9	245	25.4	76.2	4.67
11.101048868	11.5	289	127	62	70	192	76	57	67	375	56.5	289	28.7	101	8.8
11.101048880	16	311	143	63	79	212	82.5	66	74.5	417	61	311	31.8	101	10.5
11.101048889	22	424	180	95.5	104	263	108	76	89	542	81	424	38.1	127	21.3
11.101025688	31.5	459	180	95.5	104	346	127	93	118	590	82.6	459	38.1	165	32