

Wall Socket for Swivel Davit Crane, Zinc Plated

Product information



Wall socket with zinc plating, suitable for Gebuwin Swivel Davit cranes SD models: SD125, SD250, SD500 en SD501.

... [Read more](#)

Material: Steel
Finish: Galvanized

Wall Socket for Swivel Davit Crane, Zinc Plated

Blueprint

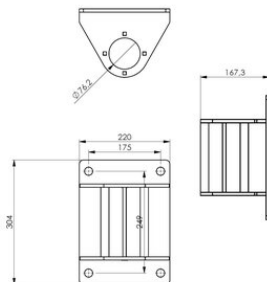

Technical data

| Part code | Code | Weight kg |
|-----------|------|--------------|
| 77001844 | WSSD | 7.6 |