

## Battery Drill Winch WA200

### Product information



This battery drilling machine winch is a user-friendly winch and is often used as a back-up system. If the power fails and you want to move a heavier load quickly and effectively, the use of a battery powered drill offers a solution. The winch is very compact and can be mounted both against the wall and on the floor. Ideal for smaller work.

- Robust and safe lifting and pulling winch operated with battery drill
- Flexible coupling attachment for battery drill
- Self braking worm gear system
- Suitable for wall or floor (console) mounting
- Suitable for short lifting lengths
- Maintenance free aluminum closed gear box
- In compliance with DIN 15020
- Painted frame with thickness 60 - 80 micron in 1 layer (RAL 7035 - grey) and zinc-plated finished cable drum

... [Read more](#)

**Features:** Max. input rotation speed drill 1400 rpm

**Material:** Steel

**Marking:** According to standard, CE-marked

**Finish:** Painted, grey / zinc-plated finished cable drum

**Standard:** EN 13157

**Note:** Steel wire ropes must be ordered separately

**Safety factor:** 4:1

## Battery Drill Winch WA200

### Blueprint

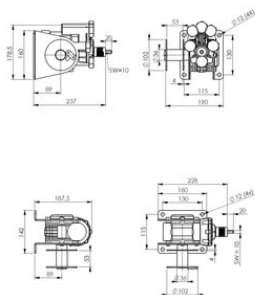

### Technical data

Code	WLL ton	Rope Ø mm	Rope capacity m	Capacity top layer kg	Lifting speed m/min.	Weight kg
WA200	0.2	4	18	90	0,8	6