

## Bow Shackle Powertex PBSB

### Product information



### POWERTEX

The POWERTEX Bow Shackle PBSB is a high-strength lifting shackle designed for demanding industrial environments. Supplied with a hexagon head safety bolt, nut, and stainless steel cotter pin, it provides a secure connection for overhead lifting and rigging.

The bow shape allows for multi-directional loading, making it suitable for use with slings, chains, and wire rope assemblies. Manufactured from quenched and tempered alloy steel and hot dip galvanized, it is built for reliable daily use in construction, manufacturing, offshore, and heavy maintenance operations.

It complies with EN 13889, AS 2741 (generally), ASME B30.26, and meets the performance requirements of the US Fed. Spec. RR-C-271.

#### Choose the PBSB safety bolt version when:

- The shackle will remain in place for longer periods
- Vibrations or dynamic loads could cause a screw pin to rotate
- Higher safety assurance is required as part of site procedures
- You need clear traceability and batch identification for audits

#### Product benefits

- **Safety bolt with nut and stainless steel cotter pin**  
Provides a mechanically secured connection that reduces the risk of accidental loosening under vibration or dynamic loads.
- **Wide operating temperature range from -40°C up to +200°C**  
Suitable for both cold outdoor conditions and warm industrial environments, giving predictable performance across a wide range of applications without changing lifting equipment.
- **Forged alloy steel, quenched and tempered, Grade 6**  
Delivers consistent strength and predictable performance in demand ... [Read more](#)

**Material:** Forged alloy steel, supplied with safety bolt and nuts. Stainless steel retaining pins.

**Marking:** According to standard, CE-marked, Powertex (PX or PTEX), WLL, size, grade and batch number.

**Temperature range:** -40°C up to +200°C

**Finish:** All parts hot dip galvanized + head-bolt and nut additional powder painted.

**Standard:** EN 13889, AS 2741, ASME B30.26

**Safety factor:** 6:1

**Grade:** 6

## Bow Shackle Powertex PBSB

### Blueprint

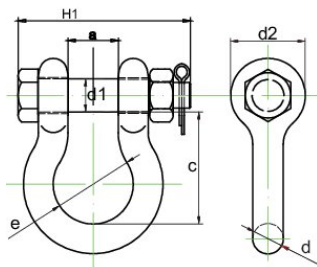

### Technical data

Part code	WLL ton	EWL mm	Size inch	a* mm	c* mm	d mm	d1 mm	d2 mm	e mm	H1 mm	Weight kg
11.31PBSB00050	0.5	29	1/4	13	29	6.5	8	17.5	20	42.5	0.05
11.31PBSB00075	0.75	31	5/16	13.5	31	8	9.5	21	21.5	47	0.1
11.31PBSB00100	1	37	3/8	17	37	10	11.2	25	26.2	56.5	0.15
11.31PBSB00150	1.5	43	7/16	18.5	43	11.3	12.7	27	29.5	63.5	0.22
11.31PBSB00200	2	48	1/2	20.6	48	12.7	15.8	30.5	33.3	75.5	0.36
11.31PBSB00325	3.25	60	5/8	27	60	16	18.8	40	43	92	0.76
11.31PBSB00475	4.75	72	3/4	32	72	19	22	48	51	106	1.2
11.31PBSB00650	6.5	85	7/8	37	85	22	25	54	58	120	1.8
11.31PBSB00850	8.5	96	1	43.5	96	26.5	28	60	68.5	135	2.6
11.31PBSB00950	9.5	109	1-1/8	48	109	29	32	68	75	143	3.8
11.31PBSB01200	12	121	1-1/4	53	121	32	35	76	84	164	5.3
11.31PBSB01350	13.5	134	1-3/8	59	134	35	38	84	94	182	7.2
11.31PBSB01700	17	149	1-1/2	62	149	38	42	92	99	195	9.4
11.31PBSB02500	25	178	1-3/4	75	178	45	50	106	128	224	15
11.31PBSB03500	35	197	2	84	197	52	56	122	148	248	24
11.31PBSB05500	55	270	2-1/2	107	270	66	70	145	186	302	45
11.31PBSB08500	85	325	3	130	325	76	80	165	205	395	70