

Stainless Toggle Terminal

Product information

Stainless steel Toggle terminals for pressing or swaging onto stainless steel wire rope ends.

... [Read more](#)



Material: Stainless steel AISI 316.

Marking: logo, wire size and swage depth.

Temperature range: -50°C to +100°C and briefly up to +200°C

Finish: High polished.

Stainless Toggle Terminal

Blueprint

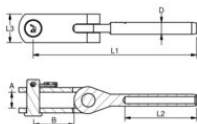

Technical data

Part code	Rope diameter mm	Pin diameter mm	MBL ton	A mm	B mm	D mm	L1mm mm	L2mm mm	L3 mm mm	Weight kg/100pc
1207500603	3	6.35	1.3	8	17	6.35	81	38	14	4.3
1207500804	4	8	1.7	10	25	7.5	94	45	18	6.9
1207509505	5	9.5	2.4	12	27	9	116	51	23	13.8
1207501206X	6	11	4.7	15	29	12.58	135	64	30	27.3
1207501308	8	12.7	6.5	18	33	16	198	83	35	37.5
1207501610	10	15.9	9.7	20	41	17.8	192	89	35	64.3