

## Stainless Fork Terminal

---

### Product information

Fork terminals are amongst the most commonly used wire end fittings. These terminals are to be swaged on the steel wire ropes with special swage equipment.

In use, they are normally attached to pre drilled anchor plates or steel constructions. Also used in combination with toggles, eyes or U-bolts.

... [Read more](#)



**Material:** Stainless steel AISI 316.

**Marking:** Logo, wire size and swage depth.

**Temperature range:** -50°C to +100°C and briefly up to +200°C

**Finish:** Polished.

**Note:** Small fork head design is square - from Ø 19 mm pin and up the design is rounded,

**Warning:** Do not apply to the cable yourself without using suitable swaging equipment.

## Stainless Fork Terminal

### Blueprint

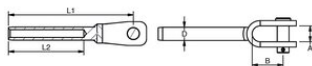

### Technical data

| Part code    | Rope diameter mm | Pin diameter mm | MBL ton | A mm | B mm | D mm | L1mm mm | L2mm mm | Weight kg/100pc |
|--------------|------------------|-----------------|---------|------|------|------|---------|---------|-----------------|
| 10.07100502  | 2                | 5               | 0.8     | 7,5  | 12   | 5,5  | 58      | 32      | 2               |
| 10.07100525  | 2.5              | 5               | 0.8     | 7,5  | 12   | 5,5  | 58      | 32      | 2               |
| 10.07100503  | 3                | 5               | 0.8     | 7,5  | 12   | 6,4  | 67      | 38      | 2.3             |
| 10.07100504  | 4                | 6               | 0.8     | 7,5  | 12   | 7,5  | 71      | 45      | 2.7             |
| 10.07100603  | 3                | 6               | 1.3     | 9,5  | 13   | 6,4  | 68      | 38      | 2.8             |
| 10.07100604  | 4                | 6               | 1.5     | 9,5  | 13   | 7,5  | 73      | 45      | 3.4             |
| 10.07100605  | 5                | 6               | 1.5     | 9,5  | 13   | 9,0  | 83      | 51      | 4.1             |
| 10.07100804  | 4                | 8               | 1.7     | 11   | 15   | 7,5  | 77      | 45      | 4.9             |
| 10.07100805  | 5                | 8               | 2.4     | 11   | 15   | 9,0  | 87      | 51      | 5.5             |
| 10.07109505  | 5                | 9.5             | 2.4     | 12   | 19   | 9,0  | 91      | 51      | 7.2             |
| 10.07100806  | 6                | 8               | 3.2     | 11   | 15   | 12,6 | 99      | 64      | 10              |
| 10.07109506  | 6                | 9.5             | 3.8     | 12   | 19   | 12,6 | 104     | 64      | 11.3            |
| 10.07101206  | 6                | 12              | 5.2     | 14   | 25   | 12,6 | 110     | 64      | 17.6            |
| 10.07101207  | 7                | 12              | 6.5     | 14   | 25   | 14,2 | 119     | 70      | 18.1            |
| 10.07101208  | 8                | 12              | 6.5     | 14   | 25   | 16,0 | 136     | 83      | 21.6            |
| 10.07101608  | 8                | 16              | 8.5     | 17   | 33   | 16,0 | 145     | 83      | 25.5            |
| 10.07101408  | 8                | 14              | 8.5     | 18   | 33   | 16,0 | 143     | 83      | 32.5            |
| 10.07101410  | 10               | 14              | 9.4     | 18   | 32   | 17,8 | 151     | 89      | 35              |
| 10.07101410L | 10               | 14              | 9.4     | 22   | 30   | 17,8 | 149     | 89      | 36              |
| 10.07101610  | 10               | 16              | 9.4     | 17   | 33   | 17,8 | 149     | 89      | 36.6            |
| 10.07101910  | 10               | 19              | 9.4     | 24   | 48   | 17,8 | 168     | 89      | 47.7            |
| 10.07101612  | 12               | 16              | 11.2    | 17   | 33   | 20,0 | 174     | 105     | 60              |

## Stainless Fork Terminal

### Technical data

| Part code    | Rope diameter mm | Pin diameter mm | MBL ton | A mm | B mm | D mm | L1mm mm | L2mm mm | Weight kg/100pc |
|--------------|------------------|-----------------|---------|------|------|------|---------|---------|-----------------|
| 10.07101612L | 12               | 16              | 11.2    | 22   | 31   | 20,0 | 171     | 105     | 60              |
| 10.07101912  | 12               | 19              | 11.2    | 24   | 48   | 20,0 | 189     | 105     | 66              |
| 10.07101912L | 12               | 19              | 11.2    | 30   | 47   | 20,0 | 187     | 105     | 66              |
| 10.07101912X | 12               | 19              | 14      | 24   | 48   | 21,4 | 205     | 120     | 75              |
| 10.07101914L | 14               | 19              | 15      | 30   | 47   | 25,0 | 221     | 140     | 75              |
| 10.07102214  | 14               | 22              | 15      | 30   | 57   | 25,0 | 232     | 140     | 112.7           |
| 10.07102514  | 14               | 25.4            | 15      | 30   | 62   | 25,0 | 235     | 140     | 125             |
| 10.07102516  | 16               | 25.4            | 19      | 30   | 62   | 28,0 | 264     | 160     | 140             |
| 10.07102216  | 16               | 22              | 19      | 30   | 57   | 28,0 | 260     | 160     | 141             |
| 10.07102819  | 19               | 28              | 27      | 32   | 68   | 34,5 | 309     | 200     | 246             |
| 10.07103222  | 22               | 32              | 34      | 35   | 76   | 40,5 | 354     | 230     | 372             |
| 10.07103526  | 26               | 35              | 45      | 40   | 86   | 46,0 | 420     | 280     | 548             |