

Geared Trolley Powertex PGT-S2

Product information



POWERTEX

Powertex Geared Trolley PGT-S2 is a high quality, durable low built push trolley that is easy to install on horizontal beams and rails.

The trolleys can be used for I-beams with plane flanges (such as IPE, HEA or HEB types) or beams with sloping flanges (such as INP-beams).

The trolley can easily be positioned along the beam using the hand chain thanks to high quality steel wheels with bearings.

Features:

- Safe - All Powertex trolleys are proof load tested 1,5 x WLL
- Mechanical stops integrated in the design to prevent derailing
- Equipped with connection plate with eye to hoist's upper hook or direct connection
- Connection plate can be turned 90 degrees to allow direct connection to Powertex S2 hoists without need of intermediate hook/eye
- Rubber bumpers to absorb shock loads on impact to rail ending
- Equipped with RFID for quick registration and maintenance
- Marked with QR code to allow access to User manuals at any time
- PGT-S2 is easy to mount and dismount on a horizontal rail or beam
- The 3 piece design makes installation quick and ergonomically
- The shaft is easily locked using the Lock plate (No need to use large castle nut nor collar pins)
- Wheel shafts are robotic welded for high quality weld seams
- Large steel wheels equipped with double sided sealed bearings that do not need ... [Read more](#)

Marking: According to standard, CE-marked, WLL, beam width, individual serial number

Temperature range: -10°C up to +50°C.

Finish: Black powder painted (Matt finish)

Standard: EN 13157, AS 1418.2

Safety factor: 4:1

Geared Trolley Powertex PGT-S2

Blueprint

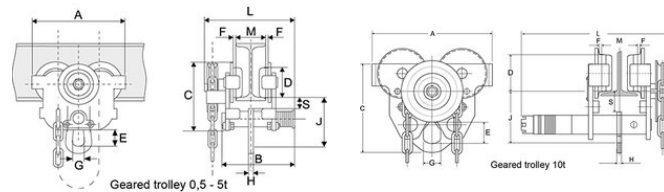

Technical data

Part code	WLL ton	Beam width mm	Model	Minimum radius mm	Hand chain length m	A mm	B mm	C mm	D mm	E mm	F mm	G, mm	H, mm	J mm	L mm	S mm	Weight kg
16.05PGTS2005	0.5	50-135	PGT-S2	800	3	205	198	150	55	30	1,5 - 2	28	8	111	239	27	8
16.05PGTS2005B	0.5	130-215	PGT-S2	800	3	205	278	150	55	30	1,5 - 2	28	8	111	319	27	8.8
16.05PGTS2005C	0.5	215-300	PGT-S2	800	3	205	363	150	55	30	1,5 - 2	28	8	111	404	27	9.6
16.05PGTS2010	1	55-140	PGT-S2	1,000	3	242	211	174	68	30	1,5 - 2	32	10	118	254	28	12.4
16.05PGTS2010B	1	140-215	PGT-S2	1,000	3	242	286	174	68	30	1,5 - 2	32	10	118	329	28	13.4
16.05PGTS2010C	1	215-300	PGT-S2	1,000	3	242	371	174	68	30	1,5 - 2	32	10	118	414	28	14.7
16.05PGTS2020	2	65-155	PGT-S2	1,100	3	270	238	194	80	49	1,5 - 2	40	12	147	277	27	18.1
16.05PGTS2020B	2	150-230	PGT-S2	1,100	3	270	313	194	80	49	1,5 - 2	40	12	147	352	27	19.3
16.05PGTS2020C	2	230-300	PGT-S2	1,100	3	270	383	194	80	49	1,5 - 2	40	12	147	422	27	20.5
16.05PGTS2030	3	90-160	PGT-S2	1,300	3	325	246	234	100	60	2 - 3	49	14	177	287	29	30.3
16.05PGTS2030B	3	160-230	PGT-S2	1,300	3	325	316	234	100	60	2 - 3	49	14	177	357	29	31.9
16.05PGTS2030C	3	230-300	PGT-S2	1,300	3	325	386	234	100	60	2 - 3	49	14	177	427	29	33.5
16.05PGTS2050	5	90-180	PGT-S2	1,500	3	370	280	267	110	79	2 - 3	59	16	219	320	29	46.5
16.05PGTS2050B	5	180-230	PGT-S2	1,500	3	370	330	267	110	79	2 - 3	59	16	219	370	29	48.2
16.05PGTS2050C	5	230-300	PGT-S2	1,500	3	370	400	267	110	79	2 - 3	59	16	219	440	29	50.6
16.05PGTS2100	10	124-305	PGT-S2	2,000	3	442	-	396	136	137	2 - 3.5	92	30	190	525	45	94