

Bow Shackles BN Green Pin® G-4163

Product information

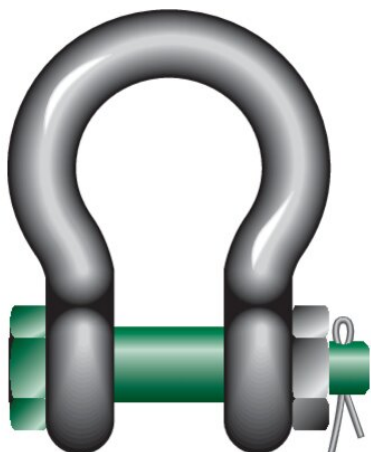

The Green Pin® Bow Shackle BN is a bow shackle with a safety bolt. The shackle offers a double safety (split pin and safety bolt) which prevents accidental unscrewing of the pin. Long-term durability is assured due to the galvanization of the Green Pin® Bow Shackle BN. Of course, the Green Pin® Bow Shackle BN conforms to a wide range of certifications from class societies such as DNV GL. The Green Pin® Bow Shackle BN is suitable for both one-leg and multi-leg systems and is available in a range with a working load limit from 0.5 up to 85 ton.

Certification on request: 2.1, 2.2, 3.1, MTCa, DNV 2.7-1a, DNV 2.7-1b, DNVGL-ST-0378, ABS PDA, ABS MA

[... Read more](#)

Material: Bow and pin high tensile steel, quenched and tempered

Marking: According to standard, CE-marked

Temperature range: -40°C up to +200°C

Finish: Hot dip galvanized

Standard: EN 13889

Safety factor: 6:1

Grade: 6

Bow Shackles BN Green Pin® G-4163

Blueprint

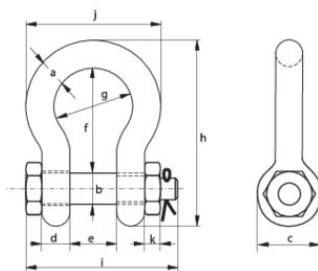

Technical data

| Part code | WLL ton | a mm | b mm | c mm | d mm | e mm | f mm | g mm | h mm | i mm | j mm | k mm | Weight kg |
|---------------|---------|------|------|------|------|------|------|------|------|------|------|------|-----------|
| 11.31GPGHMB06 | 0.5 | 7 | 8 | 16,5 | 7 | 12 | 29 | 20 | 48,5 | 42 | 34 | 4 | 0.06 |
| 11.31GPGHMB08 | 0.75 | 9 | 10 | 20 | 9 | 13,5 | 32 | 22 | 56 | 50 | 40 | 5 | 0.11 |
| 11.31GPGHMB10 | 1 | 10 | 11 | 22,5 | 10 | 17 | 36,5 | 26 | 63,5 | 60 | 46 | 8 | 0.16 |
| 11.31GPGHMB11 | 1.5 | 11 | 13 | 26,5 | 11 | 19 | 43 | 29 | 74 | 67 | 51 | 11 | 0.22 |
| 11.31GPGHMB13 | 2 | 13,5 | 16 | 34 | 13 | 22 | 51 | 32 | 89 | 82 | 58 | 13 | 0.42 |
| 11.31GPGHMB16 | 3.25 | 16 | 19 | 40 | 16 | 27 | 64 | 43 | 110 | 98 | 75 | 17 | 0.74 |
| 11.31GPGHMB19 | 4.75 | 19 | 22 | 46 | 19 | 31 | 76 | 51 | 129 | 114 | 89 | 19 | 1.18 |
| 11.31GPGHMB22 | 6.5 | 22 | 25 | 52 | 22 | 36 | 83 | 58 | 144 | 130 | 102 | 22 | 1.77 |
| 11.31GPGHMB25 | 8.5 | 25 | 28 | 59 | 25 | 43 | 95 | 68 | 164 | 150 | 118 | 25 | 2.58 |
| 11.31GPGHMB28 | 9.5 | 28 | 32 | 66 | 28 | 47 | 108 | 75 | 185 | 166 | 131 | 27 | 3.66 |
| 11.31GPGHMB32 | 12 | 32 | 35 | 72 | 32 | 51 | 115 | 83 | 201 | 178 | 147 | 30 | 4.91 |
| 11.31GPGHMB35 | 13.5 | 35 | 38 | 80 | 35 | 57 | 133 | 92 | 227 | 197 | 162 | 33 | 6.54 |
| 11.31GPGHMB38 | 17 | 38 | 42 | 88 | 38 | 60 | 146 | 99 | 249 | 202 | 175 | 19 | 8.19 |
| 11.31GPGHMB45 | 25 | 45 | 50 | 103 | 45 | 74 | 178 | 126 | 300 | 249 | 216 | 23 | 14.22 |
| 11.31GPGHMB50 | 35 | 50 | 57 | 111 | 50 | 83 | 197 | 138 | 331 | 269 | 238 | 26 | 19.85 |
| 11.31GPGHMB57 | 42.5 | 57 | 65 | 130 | 57 | 95 | 222 | 160 | 377 | 301 | 274 | 29 | 28.33 |
| 11.31GPGHMB65 | 55 | 65 | 70 | 145 | 65 | 105 | 260 | 180 | 433 | 330 | 310 | 32 | 39.59 |
| 11.31GPGHMB75 | 85 | 75 | 83 | 162 | 73 | 127 | 329 | 190 | 527 | 380 | 340 | 39 | 62 |