

Sling Shackle BN Green Pin® P-6033

Product information

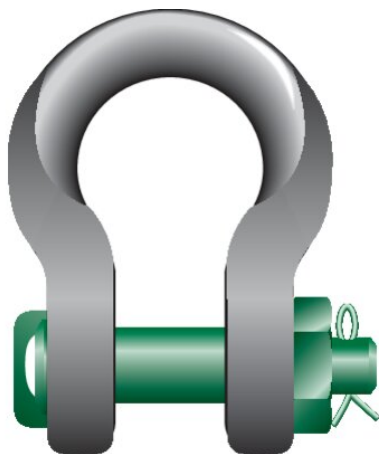

The Green Pin® Sling Shackle BN is a high load capacity bow shackle with a safety bolt and a fixed nut. The Sling Shackle BN is an excellent choice for heavy lifting projects due to the shape of the shackle crown. Compared to the standard Green Pin® Heavy Duty Shackles, Sling Shackles have an increased bow radius to improve your sling's resistance to wear and tear and enable you to use a lighter wire rope to lift the same heavy load. This means that by using the Green Pin® Sling Shackle BN you can save on wire rope costs (however, the Green Pin® Power Sling shackle offers even bigger savings). The shackle also offers a double safety (split pin and safety bolt) which prevents accidental unscrewing of the pin. Of course, galvanization of the Green Pin® Sling Shackle BN ensures long-term durability. A wide range of certifications is also available: Green Pin® Sling Shackles BN of 75 tons and higher include a Lloyd's proofload test certificate for example. The Green Pin® Sling Shackle BN is available in a range with a working load limit from 7 up to 1550 tons.

Certification on request: 2.1, 2.2, 3.1, MTCb, LROS, MPIb, USb

[... Read more](#)

Material: Bow and pin alloy steel, quenched and tempered

Marking: CE-marked

Temperature range: -20°C up to +200°C

Finish: Shackle bow painted silver, pin painted green (7 up to 55 ton shackles are hot dipped galvanized)

Safety factor: 5:1

Grade: 8

Sling Shackle BN Green Pin® P-6033

Blueprint

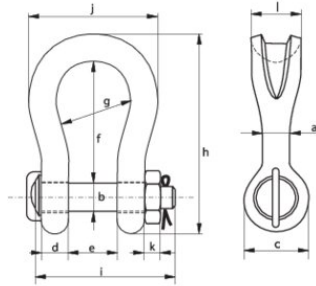

Technical data

Part code	WLL ton	a mm	b mm	c mm	d mm	e mm	f mm	g mm	h mm	i mm	j mm	k mm	l mm	Weight kg
11.34SLGPF0007	7	22	22	46	19	32	96	64	153	115	110	19	41	1.97
11.34SLGPF0012	12.5	28	28	61	25	44	120	82	197	151	146	24	54	4.27
11.34SLGPF0018	18	35	35	69	30	54	148	102	239	171	180	29	64	6.85
11.34SLGPF0030	30	40	42	90	35	69	165	126	279	207	200	34	79	12.5
11.34SLGPF0040	40	55	51	109	45	84	199	140	331	252	235	38	97	20.3
11.34SLGPF0055	55	60	57	115	55	90	240	160	389	294	270	45	100	30.4
11.34SLGPF0075	75	68	70	126	54	110	290	185	473	317	331	40	120	49
11.34SLGPF0125	125	85	80	156	85	137	366	220	583	413	390	40	150	95
11.34SLGPF0150	150	94	95	181	89	147	391	253	648	445	449	50	170	125
11.34SLGPF0200	200	110	105	201	100	158	481	280	759	480	500	50	205	190
11.34SLGPF0250	250	126	120	229	110	179	542	300	860	535	552	60	240	264
11.34SLGPF0300	300	136	134	246	134	195	601	350	946	590	620	70	265	360
11.34SLGPF0400	400	160	160	295	145	231	576	370	995	687	710	80	320	583
11.34SLGPF0500	500	170	180	330	160	263	681	450	1,161	762	850	90	340	862
11.34SLGPF0600	600	190	200	360	170	289	741	490	1,264	827	930	100	370	1,134
11.34SLGPF0700	700	200	215	392	190	315	751	540	1,284	879	901	100	400	1,360
11.34SLGPF0800	800	218	230	420	200	342	851	554	1,426	942	947	110	420	1,680
11.34SLGPF0900	900	242	255	466	220	368	851	580	1,488	1,023	1,023	120	440	1,650
11.34SLGPF1000	1,000	260	270	490	240	399	851	614	1,532	1,103	1,107	120	460	2,970
11.34SLGPF1250	1,250	285	300	510	260	452	931	650	1,666	1,227	1,182	150	530	3,700
11.34SLGPF1550	1,550	285	320	550	280	483	950	680	1,710	1,300	1,253	150	560	4,000