

Eye Foundry Hook Green Pin® UCFO

Product information



The Green Pin® Foundry Hook E is a grade 10 eye foundry hook. The throats are designed to accommodate standard trunnions, whereas the tips enable easy insertion into the holes of the melting pots. These hooks must be used for specific applications in foundries as they do not have safety latches. The Green Pin® Foundry Hook E is available in a range to suit 6 mm up to 13 mm grade 10 chain.

Certification on request: 2.1, 2.2, 3.1, MTCa, MPIb, DGUV

[... Read more](#)

Material: Alloy steel, quenched and tempered

Temperature range: -40°C up to +200°C

Finish: Painted blue

Safety factor: 4:1

Grade: 10

Eye Foundry Hook Green Pin® UCFO

Blueprint

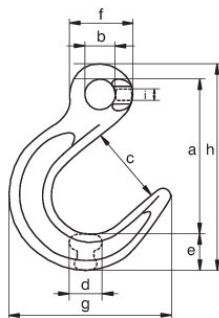

Technical data

Part code	WLL ton	For chain Ø mm	For chain Ø inch	a mm	b mm	c mm	d mm	e mm	f mm	g mm	h mm	i mm	Weight kg
11.14GPUCFO6	1.4	6	7/32	93	18	47	17	22	38	97	125	7	0.33
11.14GPUCFO8	2.6	8	5/16	124	24	63	22	30	51	129	166	9	0.78
11.14GPUCFO10	4	10	3/8	157	33	79	28	36	66	160	208	11	1.5
11.14GPUCFO13	6.8	13	1/2	190	44	93	36	46	85	198	256	14	3