

STOBITEX - PU Sharp Edge Protection Plates DF

Product information



Stobitex PU-Elastomer sharp edge protection plates DF can be used wherever there are sharp edges to be protected or where damage to lifting materials needs to be prevented. The protective plates are applied during the load fastening / lashing operation. The lashing belt is threaded through the two openings, so that the plate can slide freely along the belt. During the lashing process the belt can thus slide over the plate, avoiding damage due to no direct contact between the belt and sharp edges.

The minimum thickness "d" recommended to afford good cut protection is 4 mm.

Plates can be supplied in all sizes, with the standard sizes are listed in the table [... Read more](#)

Material: Polyurethan-Elastomer.

STOBITEX - PU Sharp Edge Protection Plates DF

Blueprint

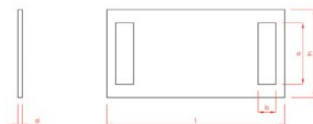

Technical data

Part code	Type	Length x Width mm	Recess a x b mm	l mm	h mm	a mm	b mm	d mm	Weight kg
12.40DF025	DF 25	250 x 80	25 x 10	250	80	25	10	5	0.11
12.40DF035	DF 35	250 x 80	35 x 10	250	80	35	10	5	0.12
12.40DF055	DF 55	300 x 100	55 x 10	300	100	55	10	5	0.17
12.40DF060	DF 60	450 x 100	60 x 30	450	100	60	30	5	0.26
12.40DF070	DF 70	450 x 120	70 x 30	450	120	70	30	5	0.3
12.40DF080	DF 80	450 x 120	80 x 30	450	120	80	30	5	0.31
12.40DF090	DF 90	470 x 130	90 x 40	470	130	90	40	5	0.33
12.40DF100	DF 100	470 x 150	110 x 40	470	150	110	40	5	0.4
12.40DF130	DF 130	470 x 170	130 x 40	470	170	130	40	5	0.43
12.40DF160	DF 160	470 x 200	160 x 40	470	200	160	40	5	0.48
12.40DF200	DF 200	470 x 240	200 x 40	470	240	200	40	5	0.54
12.40DF220	DF 220	470 x 240	220 x 40	470	240	220	40	5	0.57
12.40DF250	DF 250	500 x 280	250 x 40	500	280	250	40	5	0.7
12.40DF320	DF 320	600 x 400	320 x 40	600	400	320	40	5	1.33
12.40DF420	DF 420	600 x 500	420 x 40	600	500	420	40	5	1.93